

PUDLO Self Seal to be taken across capping beam and up to DPC level. **PUDLO Self Seal Primer** to be applied prior to **PUDLO Self Seal**.

Note :-
Concrete for wall to be S4 slump with 10mm aggregate. Concrete should not be allowed to fall more than a maximum 2.5m from the end of the static line pump or skip hopper hose.

PS Termination Strap to membrane transition.

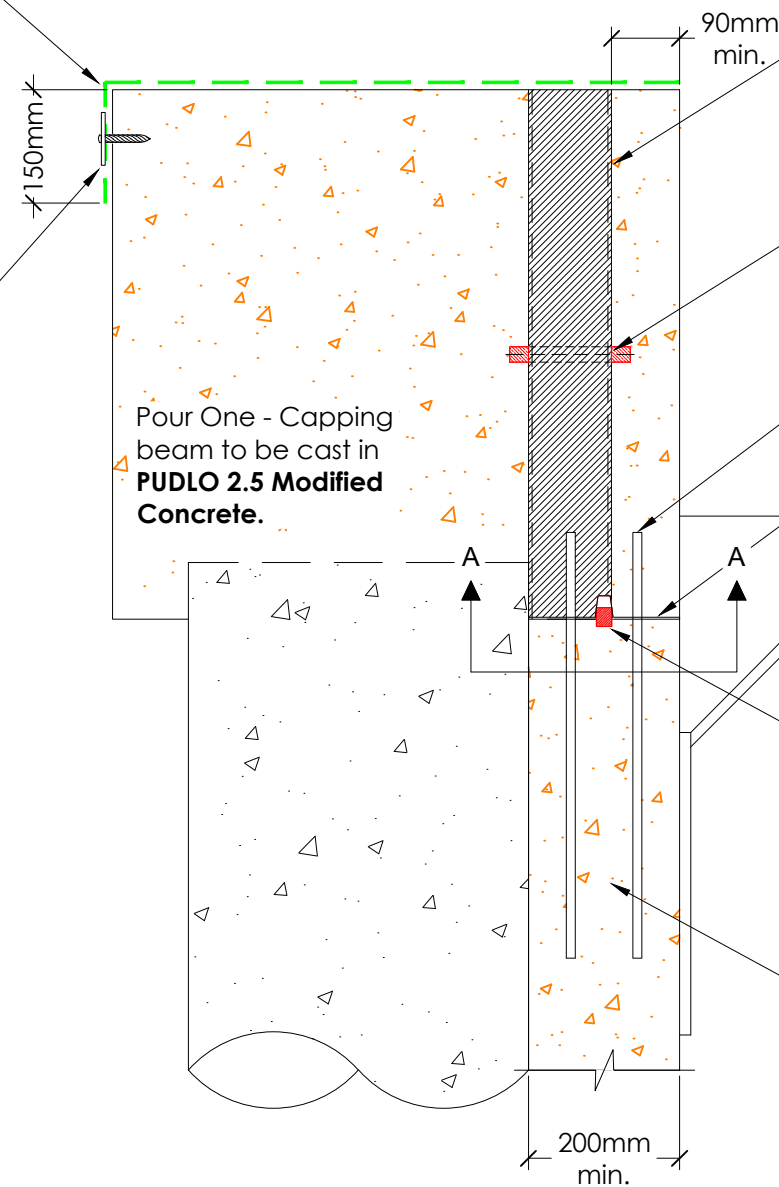

Cast-in 100-125mm dia. sleeve (dependant on wall width) for pouring concrete through pipe. Placed at 1m meter centres.

1 No. **Surestop BWB** to be secured to cast-in sleeve with tie wire prior to capping beam pour.

Reinforcement to engineers specification.

Timber stop-end to engineers spec. to be cast into capping beam with **Surestop Void Former** nailed to stop-end.

Birds mouth shutter fixed between each cast-in pipe for good compaction of concrete. Once shutter is removed break off concrete so it runs flush with wall and make good.

Surestop Void Former to be nailed to capping beam shuttering. **Surestop BWB** to be pushed into rebate and continuously adhered **Surestop Adhesive** (minimum 75mm cover). Underside of capping beam to be scabbled needle gun and jet washed prior to pour two to leave a clean, exposed aggregate.

Pour Two - Lining wall to be cast in **PUDLO 2.5 Modified Concrete**.

1 Capping Beam Detail
Scale: 1:10

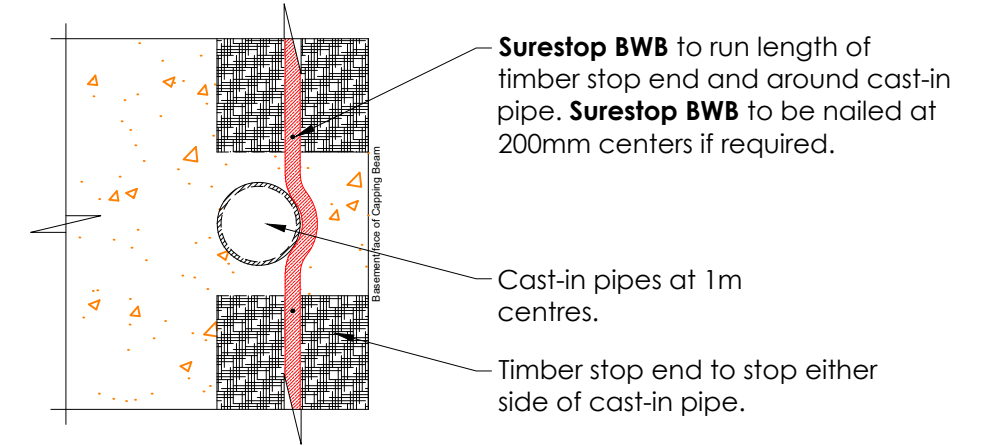

2 Section A-A
Scale: nts



Part of the DB Group

Revision History

DATE	DESCRIPTION	REV.	DES.	Q.C.
18/12/19	First issue.	-	LD	LL

DB Group (Holdings) Ltd Wellington Way, Bourn Airfield Cambridge, CB23 2TQ Tel: +44 (0)1954 780687 Email: sales@pudlo.com www.dbgholdings.com/pudlo		
DRAWING TITLE	PROJECT	
CAPPING BEAM DETAIL 2	-	
STATUS	SCALE	
FOR INFO	as shown on A3	
DRAWING NUMBER	REVISION	SHEET No.
PUDLO-TJD-P2.5-SS-025	-	1 of 1
CLIENT		

Note:-
This PUDLO detail is to assist with the installation of its products. The detail shows how PUDLO 2.5 Modified Concrete and how PUDLO ancillaries are to be installed. For site specific details and confirmation on extent of where PUDLO 2.5 Modified Concrete is used i.e. Overlay drawings, must be confirmed by structural engineers/contractor. Individual/Company responsibility for design of the structure must ensure that details shown on PUDLO drawings match the latest construction issue drawings.
The information shown on this detail is given without obligation, or warranty PRIOR to consultation or communication with PUDLO/DB Group Ltd.